

WINDOW TYPE	ELEVATION VIEW	PLAN OR SECTION VIEW
SINGLE OR DOUBLE SLIDER - FOR SLIDING WINDOWS THE CLEAR OPENING ONLY INCLUDES THE PORTION OF THE WINDOW THAT SLIDES. IT DOES NOT INCLUDE LIFTING A SASH AND REMOVING IT		PLAN
CASEMENT - THE HINGES ON A CASEMENT WINDOW MUST ALLOW THE SASH TO SWING OUT A MINIMUM 15". THIS MAY REQUIRE THE WINDOW TO HAVE SPECIAL EGRESS HINGES		PLAN
AWNING - CENTRE SUPPORT (IF APPLICABLE) CANNOT INTERFERE WITH MIN. REQUIRED CLEAR OPENING - CLEAR OPENING MUST BE MAINTAINED WITHOUT THE NEED FOR ADDITIONAL SUPPORT (SASH MUST BE SELF SUPPORTING IN OPEN POSITION)		SECTION
SINGLE OR DOUBLE HUNG - CLEAR OPENING MUST BE MAINTAINED WITHOUT THE NEED FOR ADDITIONAL SUPPORT (SASH MUST BE SELF SUPPORTING IN OPEN POSITION)		SECTION
TILT & TURN - MUST BE OPERABLE WITHOUT THE NEED FOR TOOLS OR SPECIALIZED KNOWLEDGE		PLAN

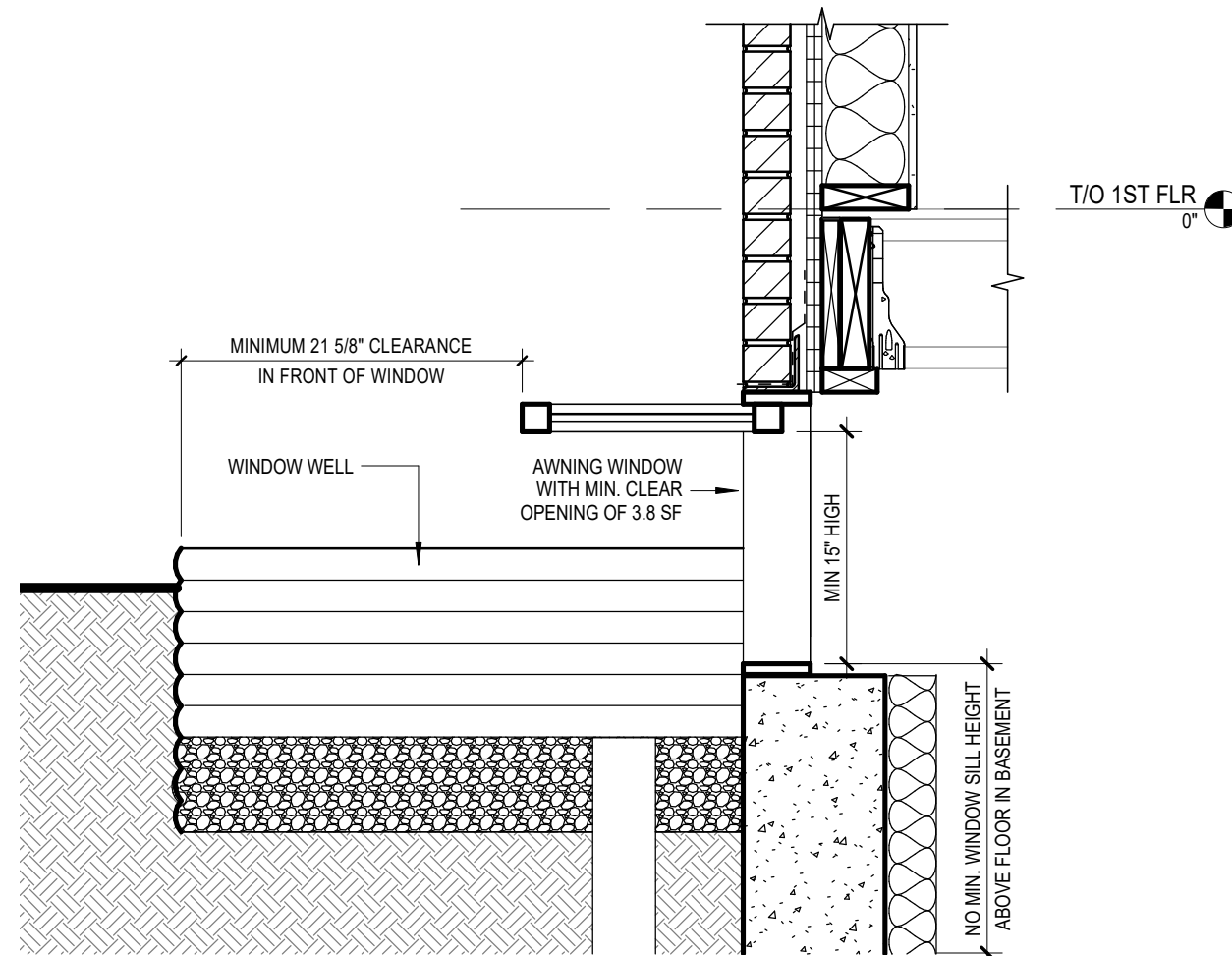

1 EGRESS WINDOW OPENING INTO WINDOW WELL
 0-6 1" = 1'-0"

It is recommended that emergency exits are not higher than 4'-11" above the floor.

ESCAPE WINDOWS: If a common exit is used for two suites, a second means of egress must be provided by using a window per specs below.

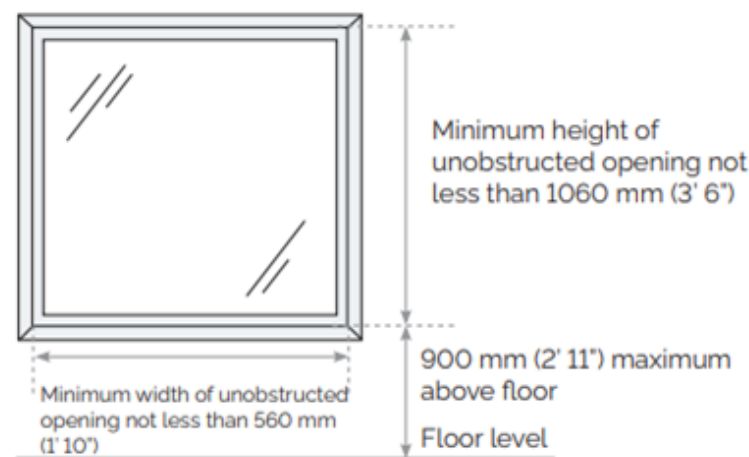

Escape window for upper floors
 (OBC Division B, Table 11.5.1.1.C, Compliance Alternative 136)

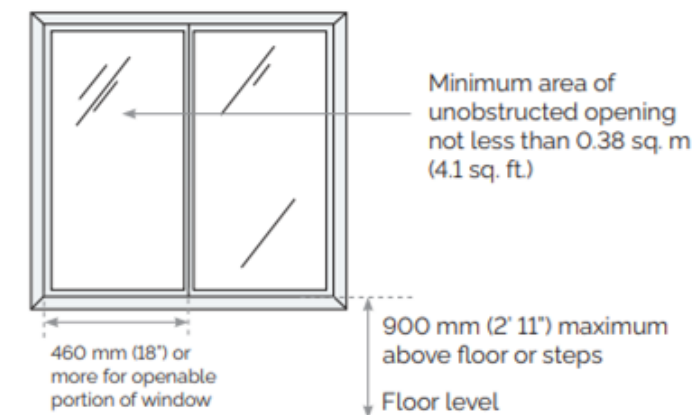

Note: Sill height no more than 1000 mm (3' 3") above or below adjacent ground level.

Ground floor or basement escape window

SAMPLE DRAWINGS

BUILDING PERMIT APPLICATION GUIDE:
EXTERIOR OPENINGS

DRAWING NAME:
SUMMARY OF EGRESS WINDOW REQUIREMENTS

NUMBER OF COPIES REQUIRED:
 N/A

DRAWING **MUST** INCLUDE/SHOW (IF APPLICABLE):
 N/A - FOR REFERENCE ONLY

DESIGNER:

PROJECT ADDRESS:

SHEET SIZE: 11" X 17"

DATE: JUNE 2018

SCALE: AS INDICATED

SHEET NO.

0-6